



## Intergate East Building 2

3311 South 120th Street Seattle WA 98168

Building 2 offers robust electrical and fiber infrastructure, and expansive floor plates to accommodate most data center, manufacturing and flex tech purposes. Generous clear heights and column spacing make space planning efficient and flexible. Attractive store front entrances, signage opportunities and ample parking. Dock high and on-grade loading.

### Highlights

- 26'8" x 60' column spacing
- 28' Clear height
- Heavy floor load
- Ample electricity
- Dock high and on-grade access
- Abundant parking

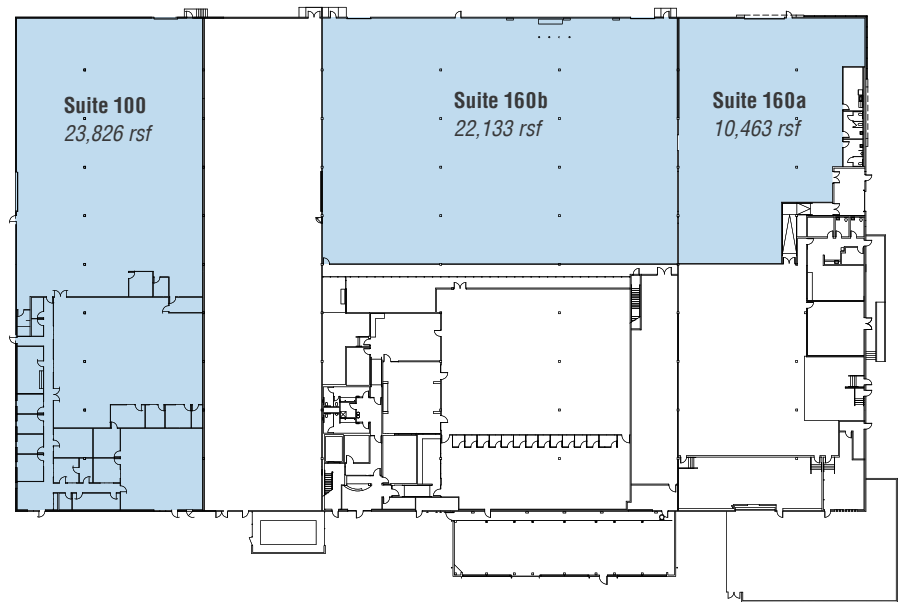

■ Total Available Space // 56,422 rsf

**Suite 100**  
Square Footage: 23,826 rsf

**Suite 160a**  
Square Footage: 10,463 rsf

**Suite 160b**  
Square Footage: 22,133 rsf

### Contacts:

Clete Casper	Joe Sabey	For Sabey Data Centers
cletec@sabey.com	joes@sabey.com	info@sabeydatacenters.com
206.277.5229	206.281.8700	206.281.8700



12201 Tukwila International Blvd. 4<sup>th</sup> Floor  
Seattle, WA 98168 | Visit us at [sabey.com](http://sabey.com)



# Intergate.East

## Technology Campus

South 120th Street, Seattle WA 98168

**Intergate.East is Sabey's flagship data center property.**

Intergate.East comprises approximately 1,200,000 square feet of data center space and is the largest privately owned multi-tenant campus on the West Coast. The campus accommodates a wide variety of tenants, including some of the world's largest and most innovative enterprises, mid-sized operators and colocation providers. Multiple buildings offer many opportunities for a full range of build to suit and turnkey data center solutions as well as manufacturing and flextech space.

With easy access from Hwy 99/509, I-5 or I-405, Intergate.East is ideal for businesses requiring access to SeaTac Airport, a mere ten minutes away or to Boeing Field, accessed in even less time. Downtown Seattle is easily reached in fifteen minutes.



**Contacts:**

Clete Casper  
 cletec@sabey.com  
 206.277.5229

Joe Sabey  
 joes@sabey.com  
 206.281.8700

For Sabey Data Centers  
 info@sabeydatacenters.com  
 206.281.8700



12201 Tukwila International Blvd. 4th Floor  
 Seattle, WA 98168 | Visit us at [sabey.com](http://sabey.com)